



21 Tampines Avenue
Singapore 529757

IT Services Department

**Temasek Polytechnic Student Guide for
Installing Adobe CC into Student's Notebook (BYOD)**

Contents

1. Installing Adobe CC into your BYOD	3
2. List of software available in Adobe CC	4
3. Contact Us	5

1. Installing Adobe CC into your BYOD

Step 1: Launch your internet browser.

Step 2: Download & install the advertised software in <https://creativecloud.adobe.com/apps/download/creative-cloud> into your device via Wi-Fi

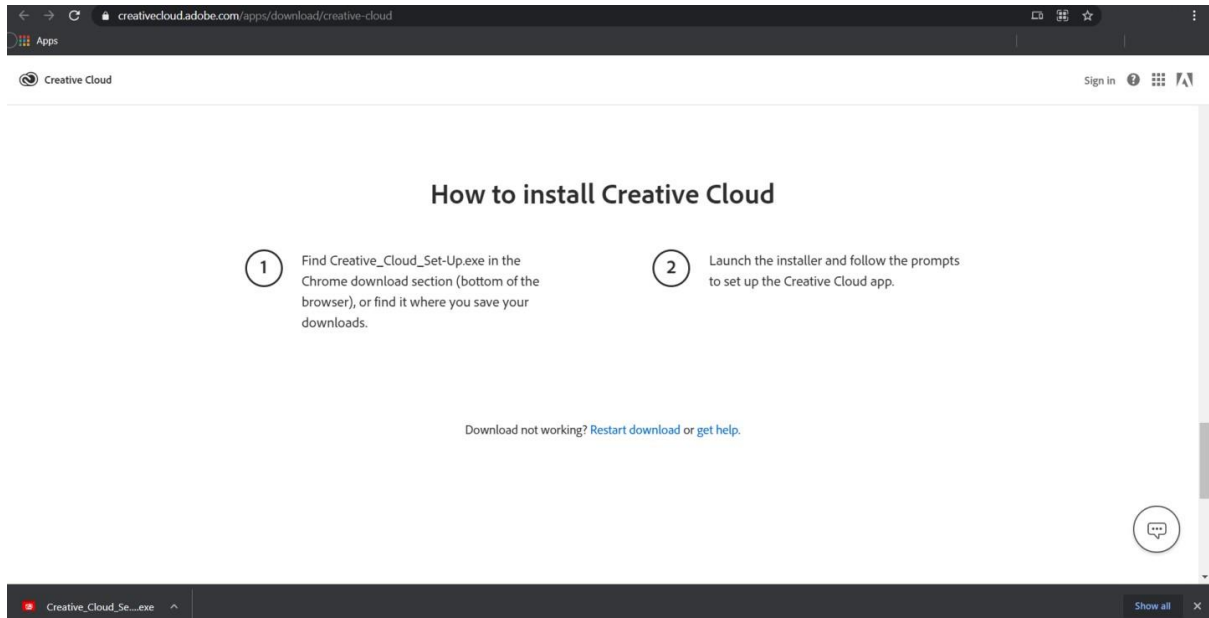

Video Guide: <https://web.microsoftstream.com/video/95b25002-8cce-47cf-8768-410e6a3cecd6>

Note: You would need an Adobe Account to manage and use the Adobe suite of software. Please contact ITS Helpdesk if you do not have one.

2. List of software available in Adobe CC



3. Contact Us

For any further enquiries or issues, contact TP's IT Service Management (ITSM) Centre at 6780 5933 or email at itsm@tp.edu.sg. Our center is located at East Wing Building, Block 1A, Level 4, Unit 02.

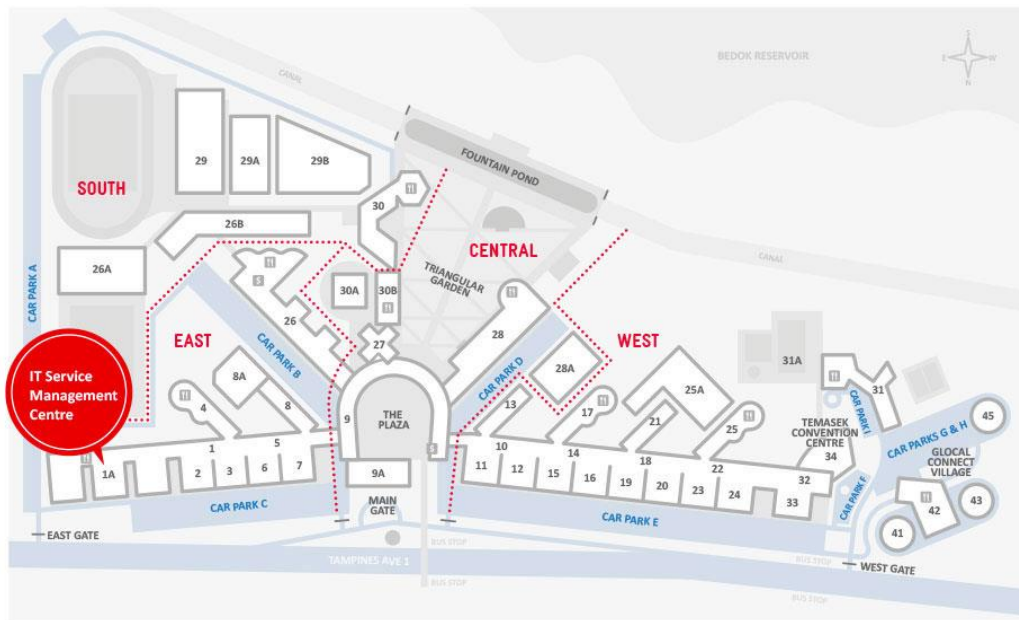

IT Service Management Centre East Wing Building, Block 1A, Level 04, Unit 02
Locate us via lift lobby 57, 58, & 59 (turn right when exit the lift)

CAMPUS MAP

The operating hours of the Centre are:

Mondays to Fridays: 8.00am to 9.30pm (except for September vacation period where closing time will be at 6.30pm)

Saturdays: 8.00am to 1.00pm